

VISITOR GUIDE & MAP

Illinois Valley Community Hospital

925 West Street, Peru, Illinois 61354
815-223-3300

IVCH FastCare Walk-in Clinic

Inside Walmart

5307 Rt. 251, Peru, Illinois 61354
815-220-3278

IVCH Center for Physical Rehabilitation and Aquatics (CPRA)

IVCH CareToday

Next to YMCA

310 Walnut St, Peru, IL 61354
815-780-3509 (CPRA)
815-780-3855 (CareToday)

VISITING HOURS

IVCH welcomes the friends and family members of our patients. Here is what you need to know about visiting an IVCH patient

Medical/Surgical Units (2 South and 3 South)

Visitors welcome anytime.

Intensive Care Unit

Call ahead, 815.780.3558, to determine if the patient you wish to visit can receive visitors. If you're at IVCH, dial 3558 on the phone in the hallway outside ICU.

Obstetrics Unit

Visiting hours for our OB patients are 11 a.m. – 8 p.m. except for partners, siblings of the newborn, and grandparents, who may visit anytime. Visiting may be limited depending upon the patient's condition, hygiene needs and breastfeeding schedule. An adult must accompany siblings of the newborn when they visit and visitors must wash their hands before having contact with the infant.

CAFETERIA

Monday through Friday

Breakfast: 7 to 10 a.m.

Lunch: 11 a.m. to 1:30 p.m.

Dinner: We have a cook-to-serve order system, and nightly specials are posted in the cafeteria. Call extension 3575 between 3 and 4:30 p.m. Orders can be picked up between 4 and 6:15 p.m.

Saturday and Sunday

Weekend meals are on a cook-to-serve order system, and weekend specials are posted in the cafeteria.

Breakfast: Closed

Lunch: Call extension 3575 between 10 a.m. and 12:30 p.m. Lunch orders can be picked up between 11 a.m. and 1:30 p.m.

Dinner: Call extension 3575 between 3 and 4:30 p.m. Dinner orders can be picked up between 4 and 6 p.m.

PARKING

Please park in designated visitor parking lots or in the IVCH parking garage across from the West Street entrance (\$0.25 fee).



FIRST FLOOR

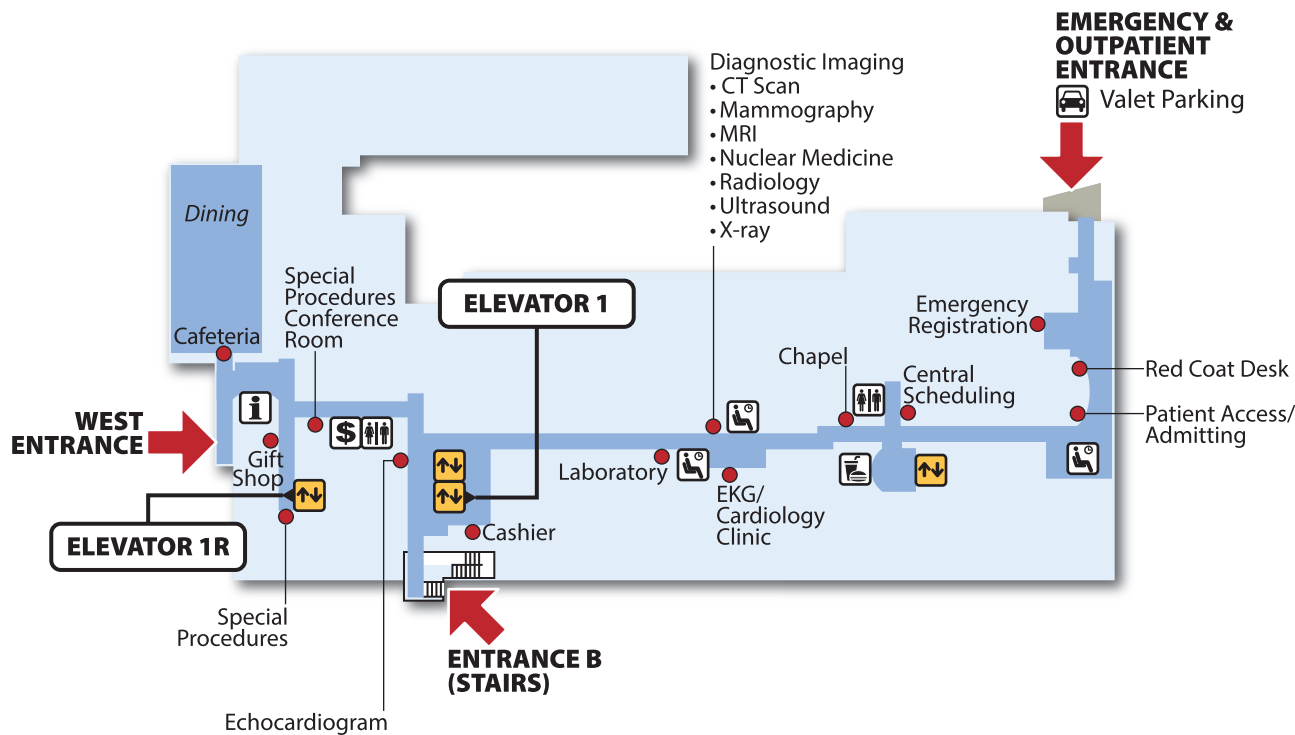

GROUND FLOOR

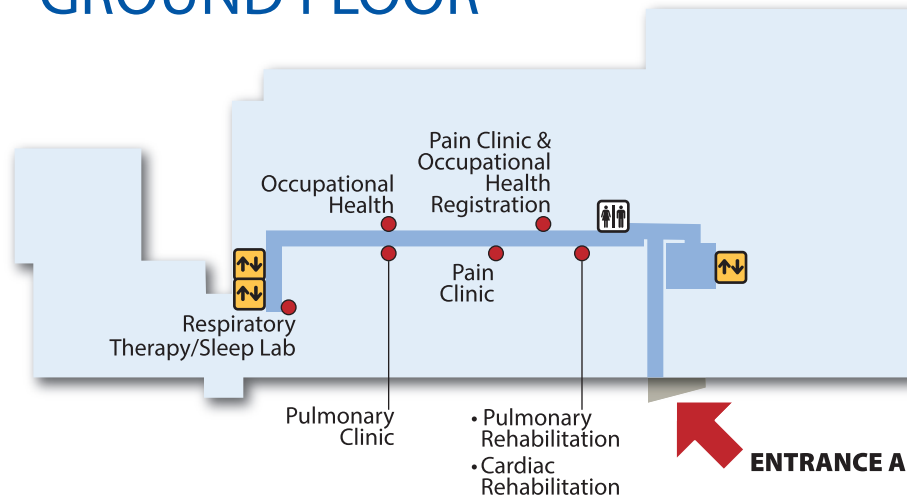

SECOND FLOOR

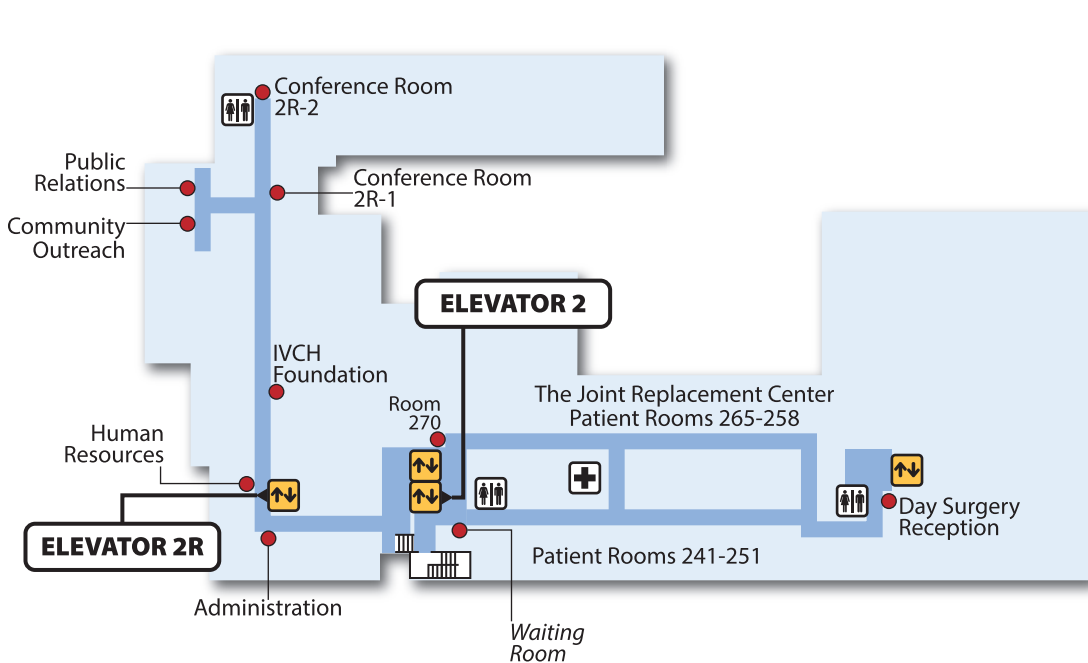

THIRD FLOOR

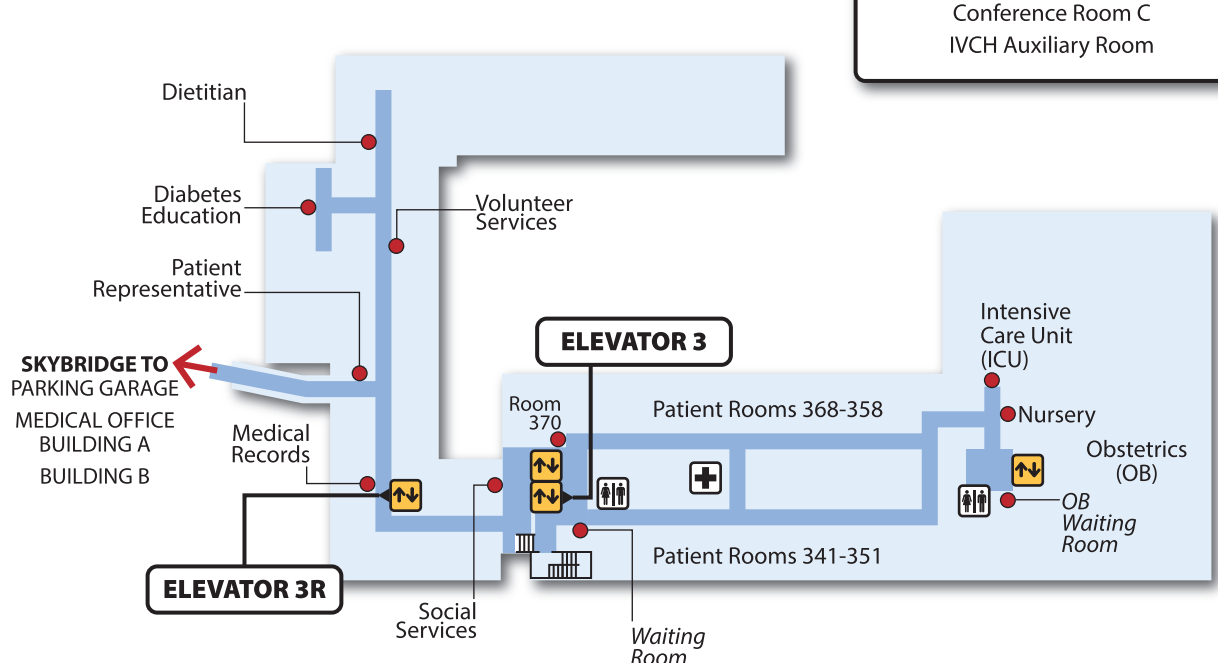

FOURTH FLOOR

Conference Room C
IVCH Auxiliary Room

DEPARTMENT

FLOOR

Administration	2
Cafeteria	1
Cardiac Rehabilitation	G
Cashier	1
Central Scheduling	1
Chapel	1
Community Outreach	2
Conference Room C	4
Conference Room 2R-2	2
Conference Room 2R-1	2
Day Surgery Reception	2
Diabetes Education	3

DEPARTMENT

FLOOR

Diagnostic Imaging	1
• CT Scan	
• Mammography	
• MRI	
• Nuclear Medicine	
• Radiology	
• Ultrasound	
• X-ray	
Dietitian	3
Echocardiogram	1
EKG/Cardiology Clinic	1
Emergency Registration	1
Gift Shop	1
Human Resources	2

DEPARTMENT

FLOOR

Intensive Care Unit (ICU)	3
IVCH Foundation	2
IVCH Auxiliary Room	4
Laboratory	1
Medical Records	3
Nursery	3
Obstetrics (OB)	3
Occupational Health	G
Pain Clinic	G
Patient Access/Admitting	1
Patient Representative	3
Patient Rooms 241-265, 270	2

DEPARTMENT

FLOOR

Patient Rooms 341-368, 370	3
Public Relations	2
Pulmonary Clinic	G
Pulmonary Rehabilitation	G
Red Coat Desk	1
Respiratory Therapy/Sleep Lab	G
Social Services	3
Special Procedures	1
Special Procedures Conference Room	1
The Joint Replacement Center	2
Patient Rooms 265-258	
Volunteer Services	3

MAP KEY

