

# TESTS & LOCATIONS

TEST TYPE	LOCATION	ENTRANCE/ELEVATOR
<b>Cardiology</b>		
EKG	Lab, 1st Floor	Main Entrance; Volunteer will escort you
Holter monitoring	Cardiology, 1st Floor	Main Entrance; Volunteer will escort you
Stress echo	Cardiology, 1st Floor	Main Entrance; Volunteer will escort you
Stress test	Cardiology, 1st Floor	Main Entrance; Volunteer will escort you
TTE	Cardiology, 1st Floor	Main Entrance; Volunteer will escort you
<b>Imaging Services /X-Ray</b>		
Bone Density	Nuclear Medicine, 1st Floor	Main Entrance; Volunteer will escort you
CT	Imaging, Lobby Level	East Entrance
Diagnostic Imaging/X-rays	Imaging, Lobby Level	East Entrance
MRI	Imaging, Lobby Level	East Entrance
Mammography	Imaging, Lobby Level	East Entrance
Nuclear Medicine	Near Cardiology, 1st Floor	Main Entrance; Volunteer will escort you
Special Procedures/ Interventional Radiology	Imaging, Lobby Level	East Entrance
Ultrasound (Sonography)	Imaging, Lobby Level	East Entrance
Vascular Ultrasound	Lobby Level	Main Entrance; Volunteer will escort you
<b>Endoscopy</b>		
Bronchoscopy	Endoscopy, Lobby Level	East Entrance
Capsule endoscopy	MaineGeneral Gastroenterology 325-E KMD, 2nd Floor	
Colonoscopy	Endoscopy, Lobby level	East Entrance
ERCP (Endoscopic Retrograde Cholangiopancreatography)	Day Surgery, 2nd Floor	East Entrance
Flexible Sigmoidoscopy	Endoscopy, Lobby Level	East Entrance
Manometry/pH probe	Endoscopy, Lobby Level	East Entrance
Upper GI endoscopy	Endoscopy, Lobby Level	East Entrance
TEE	Endoscopy, Lobby level	East Entrance
<b>Pulmonary</b>		
Bronchocholine challenge pulmonary testing	Pulmonary Testing, Basement	Dean Entrance
Labwork (CBC, AST, IgE, Alpha-1 testing, quanteferon gold)	Lab, Lobby Level	Main Entrance
Pulmonary function testing	Pulmonary Testing, Basement	Dean Entrance
Spirometry pre and post	Pulmonary Testing, Basement	Dean Entrance
Sputum AFB and cultures	Lab, Lobby Level	Main Entrance



*Your resource for life.*

**MaineGeneral**  
Medical Center

**Thayer Campus**

149 North Street • Waterville, ME 04901  
207•872•1000

Your Appointment Date: \_\_\_\_\_

Appointment With: \_\_\_\_\_

Time: \_\_\_\_\_

Entrance Location: \_\_\_\_\_

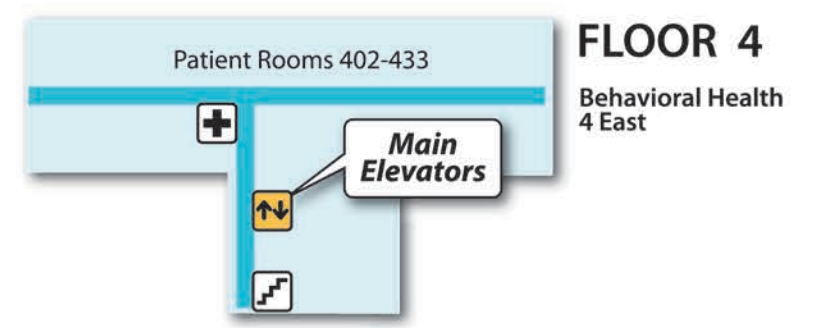
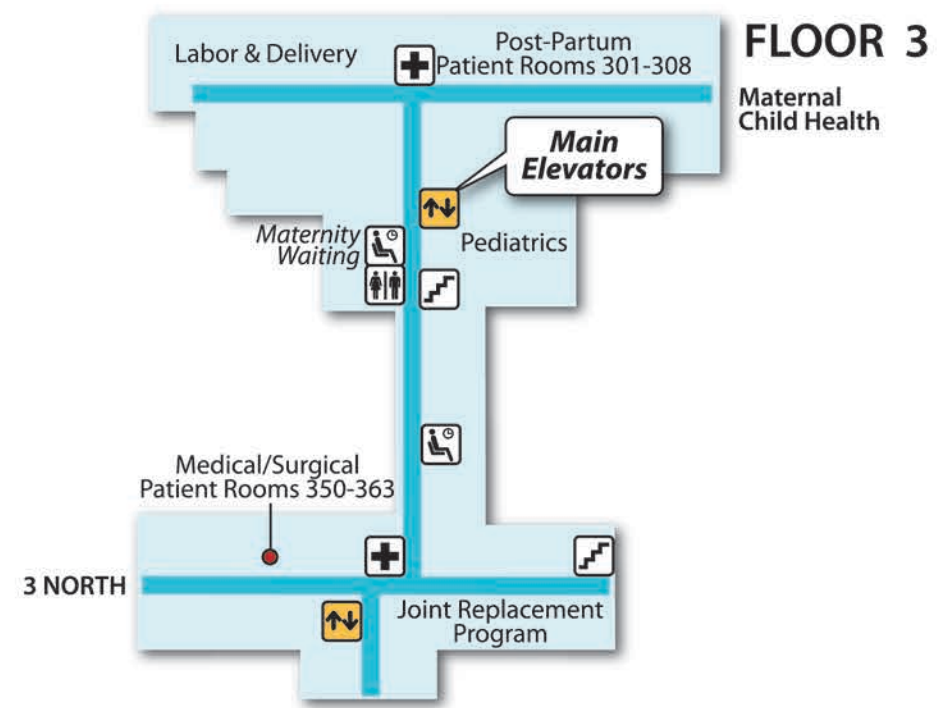
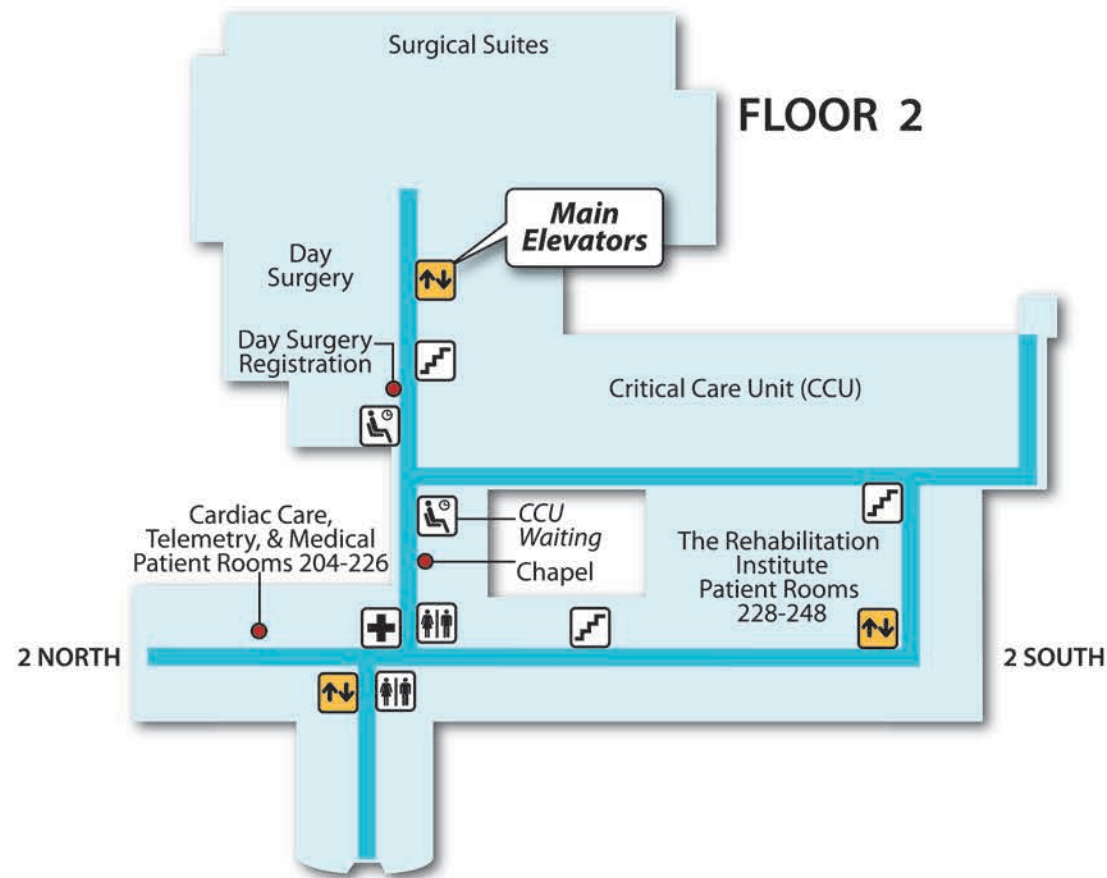
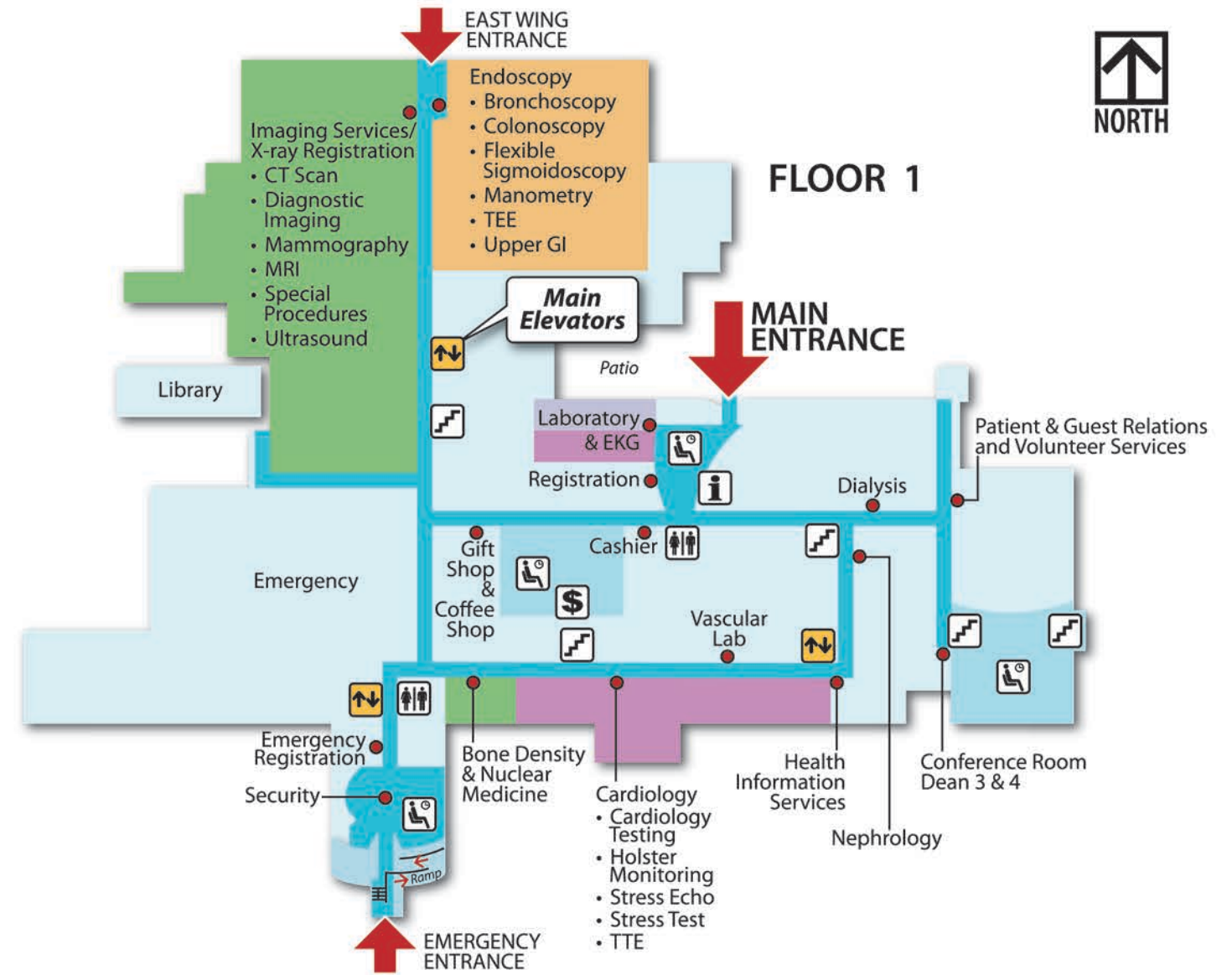
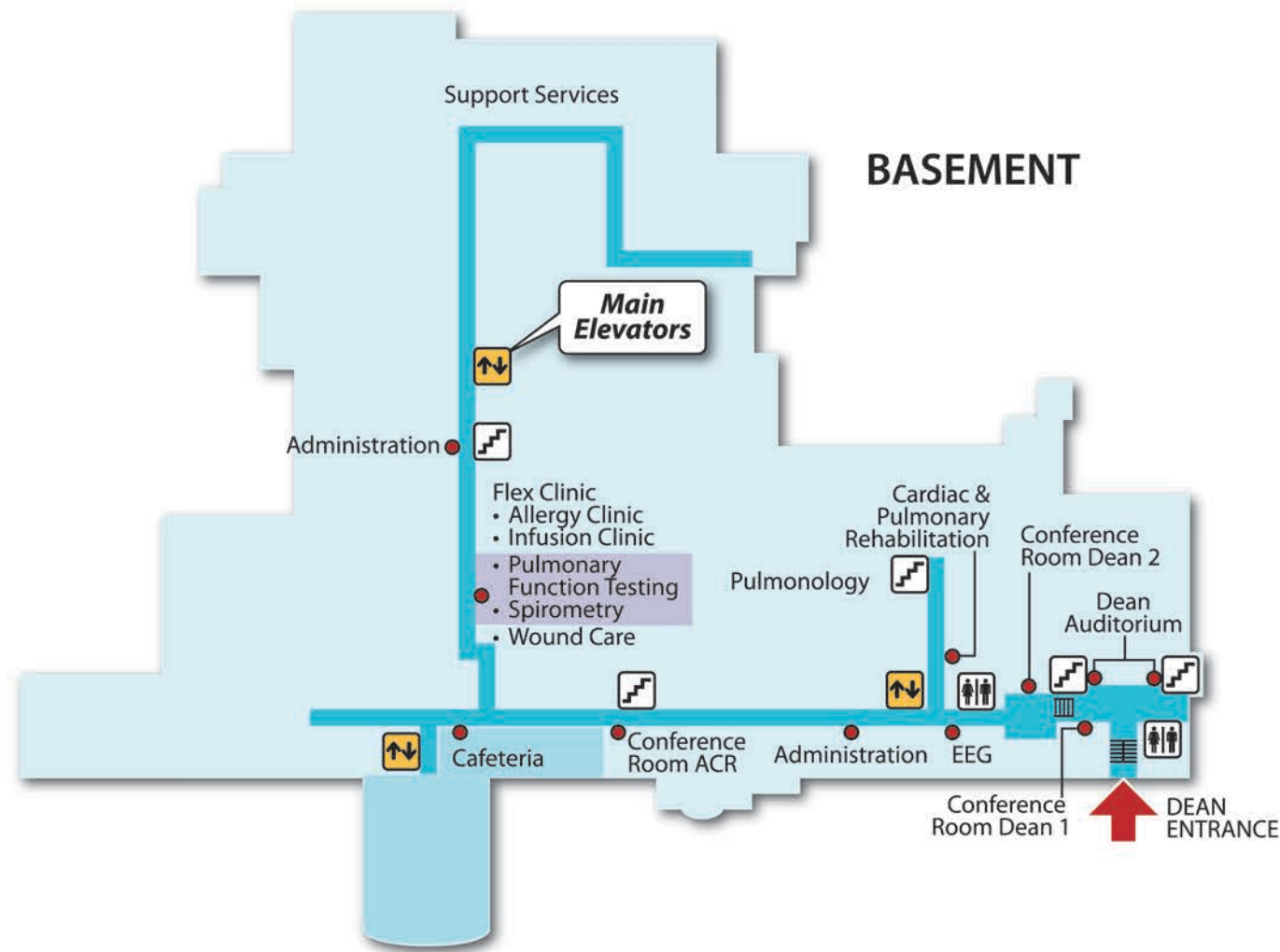

- MAP KEY**
- Information
  - Elevator
  - Stairs
  - Waiting
  - Restrooms
  - Nurse Station
  - Vending
  - ATM

To learn more,  
or get directions,  
please stop by the  
Information Desk  
or call 872-1380